

COMUNE DI VISSO
LAVORI DI RICOSTRUZIONE
PALAZZO SS. TRINITA'



STUDIO DI FATTIBILITÀ TECNICA ED ECONOMICA

TAVOLA N.	DESCRIZIONE
R.08	RILIEVO STATO LESIVO POST SISMA 2016
SCALA	PIANTE
1:100	



PROGETTISTI E DIRETTORI TECNICI

Ing. LIVIO GAMBACORTA









Arch. ROBERTO STELLA

RESPONSABILE UNICO PROCEDIMENTO

Ing. CRISTIANO FARRONI - U.T.C. VISSO

CODICE COMMESSA	Dicembre 2018	Prima Emissione
SCI-EN1	ACALE SRL: Settore strutture: Ing. Elisabetta Bersanetti Settore impianti: Ing. Laura Del Prete Coll.: Ingg. Jennifer Gasparini, Giada Francucci, Giulia Pizzichini, Archh. Francesca Vecchi, Gian Luca Buratti	

LEGENDA:

-  Lesione isolata
-  Lesione isolata passante
-  Fratturazioni concentrate, decoesioni localizzate con o senza espulsioni di parti, corrugamento intonaci (pareti)
-  Crollo
-  Distacco parete - trave/solaio
-  Distacco tra parete portante o non
-  Distacco tra parete - pilastro
-  Lesione solaio
-  Vista fotografica

PIANTA PIANO TERRA

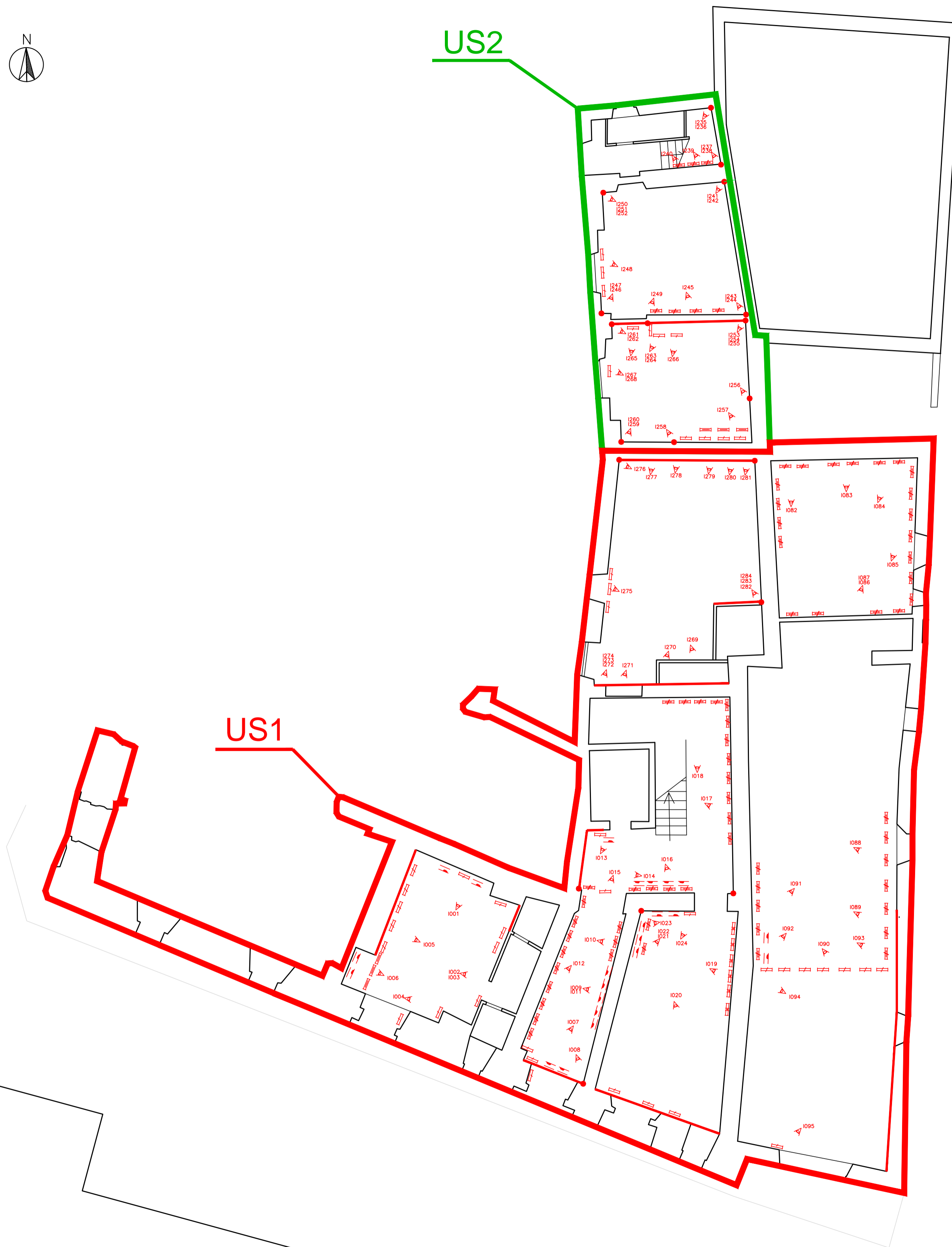

PIANTA PRIMO PIANO

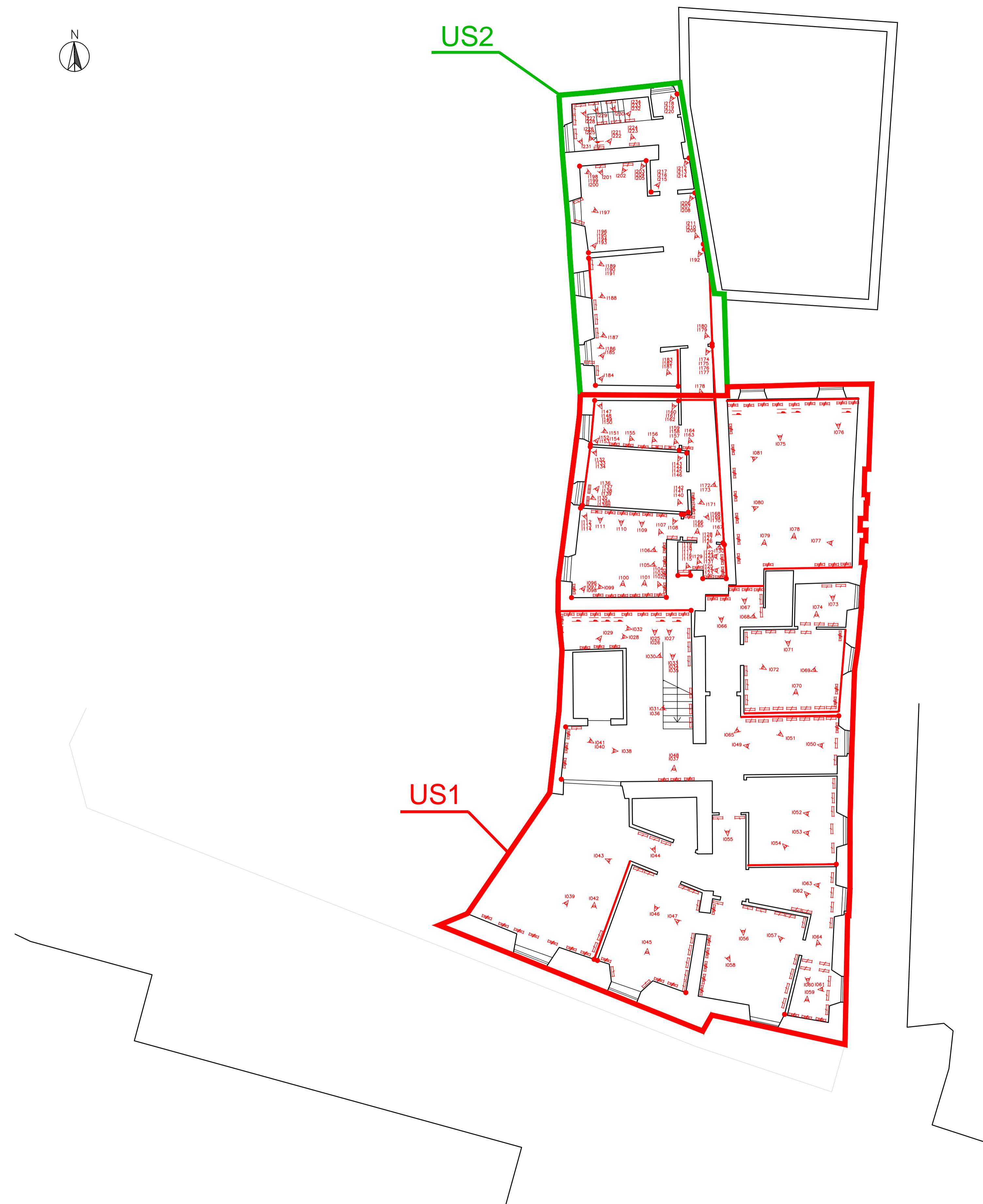

SCALA GRAFICA 1:100

